

TUBO FRENO PTFE SECONDO NORMATIVA SAE J 1401
PTFE BRAKE HOSE ACCORDING TO SAE J 1401

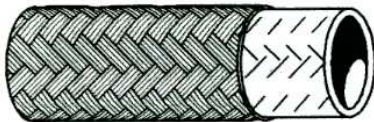

ELEMENTI COSTRUTTIVI/CONSTRUCTION

ANIMA/HOSE CORE

PTFE

RINFORZO/PRESSURE REINFORCEMENT

1 treccia in acciaio inox/1 stainless steel wire braid

APPLICAZIONI/APPLICATIONS

Attrezzature con pressioni di lavoro medie, con l'impiego di fluidi idraulici e fluidi chimicamente aggressivi ad alte temperature, DOT 3, DOT4. Prodotti per trattamenti superficiali e prodotti a due componenti. Specifico per impianti frenanti ed idoneo per la riduzione dell'effetto pulsante su impianti con sistema ABS.

Medium pressure service for use with hydraulic fluids and at high temperatures aggressive chemical fluids, DOT 3, DOT4 surface treatment products and two-components. Specific for brake equipments and suitable for reduction of pulsating effect on ABS system.

TEMPERATURE/TEMPERATURE RANGE

-60+130°C

RESISTENZA CHIMICA/CHEMICAL RESISTANCE

Vedi tabella resistenza chimica dei tubi: colonna II

See hose chemical resistance data: column II



Codice Code	Ø				Ø	Max. working pressure			Min. burst pressure			Min. Bend Radius	Weight
	DN	size	inch	mm		MPa	psi	bar	MPa	psi	bar		
OBHN1/8	3	02	1/8	3.17	6.20	21	3000	210	84	12000	840	38	45

TUBO FRENO PTFE RICOPERTO SECONDO NORMATIVA SAE J 1401
COVERED PTFE BRAKE HOSE ACCORDING TO SAE J 1401

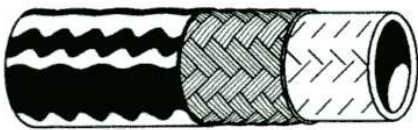

ELEMENTI COSTRUTTIVI/CONSTRUCTION

ANIMA/HOSE CORE
PTFE

RINFORZO/PRESSURE REINFORCEMENT
1 treccia in acciaio inox/1 stainless steel wire braid

RIVESTIMENTO/COVER
Poliuretano antiabrasione * /Antiabrasion polyurethane *

APPLICAZIONI/APPLICATIONS

Attrezzature con pressioni di lavoro medie, con l'impiego di fluidi idraulici e fluidi chimicamente aggressivi ad alte temperature, DOT 3, DOT4. Prodotti per trattamenti superficiali e prodotti a due componenti. Specifico per impianti frenanti ed idoneo per la riduzione dell'effetto pulsante su impianti con sistema ABS.

Medium pressure service for use with hydraulic fluids and at high temperatures aggressive chemical fluids, DOT 3, DOT4 surface treatment products and two-components. Specific for brake equipments and suitable for reduction of pulsating effect on ABS system.

TEMPERATURE/TEMPERATURE RANGE
-60+130°C

RESISTENZA CHIMICA/CHEMICAL RESISTANCE

Vedi tabella resistenza chimica dei tubi: colonna II
See hose chemical resistance data: column II



Elastollan®

Codice Code	DN size				Max. working pressure	Min. burst pressure			Min. Bend Radius	Weight			
	inch	mm	mm	mm		MPa	psi	bar			mm	g/m	
OBHR1/8 *	3/8	02	1/8	3.17	7.80	21	3000	210	84	12000	840	38	90

* Su richiesta sono disponibili i seguenti colori:
Upon request the following colours are available:

T=Trasparente/Transparent
R=Rosso/Red
B=Blu/Blue
N=Nero/Black
G=Giallo/Yellow

RACCORDI FRENO PTFE



PTFE/INOX



PTFE/INOX ricoperto



Maschio fisso corto



Maschio testa conica



Maschio fisso



M. girevole dritto



M. Girevole 90°



M. Girevole 45°



Femmina fissa



Femmina fissa larga



Femmina fissa francese



F. girevole dritta



F. girevole 90°



F. girevole 45°



E.t.



E.t. 45°



E.t. 90°



Perno saldare



occhio



Occhio 15°



Occhio 45°



Occhio 90°



Occhio laterale 15°



Occhio laterale 45°



Maschio/femmina fisso

RACCORDI FRENO RECUPERABILI PTFE



Maschio fisso



Maschio girevole



Femmina fissa



Femmina girevole



Maschio/femmina fisso



Occhio



Estremità tubolare



Raccordo tre vie



Boccola e ogiva



Bullone forato

RACCORDI RECUPERABILI PER TUBO FRENO A NORME SAE J 1401

OCCHIO DIRITTO
STRAIGHT BANJO

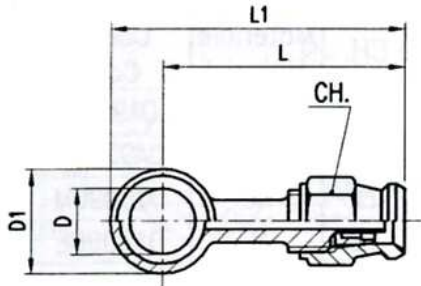

D	D1	L	L1	CH.	Materiale Material	Codice Code
10.2	16	37	44	11	AN	OADCRN
10.2	16	37	44	12	AL	0100DC1

OCCHIO 15°
BANJO SIDE 15°

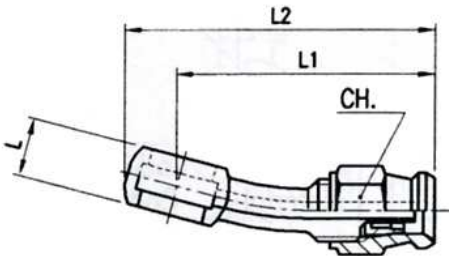

D	L	L1	L2	CH.	Materiale Material	Codice Code
10.2	9	36	44	11	AN	OA15RN
10.2	9	36	44	12	AL	010015C

OCCHIO 45°
BANJO SIDE 45°

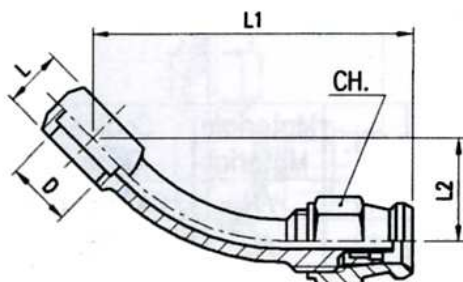

D	L	L1	L2	CH.	Materiale Material	Codice Code
10.2	9	44	14	11	AN	OA45RN
10.2	9	44	14	12	AL	010045M

RACCORDI A PRESSURE PER TUBO FRENO A NORME SAE J 1401
SWAGED FITTINGS FOR BRAKE HOSE ACCORDING TO SAE J 1401

MASCHIO FISSO CORTO
FIXED SHORT MALE

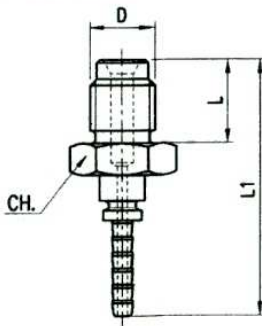

D	L	L1	CH.	Materiale Material	Codice Code
M10x1.25	13	40	14	AN	MACPON
M10x1	13	40	14	AN	MACP1N
3/8"-24	13	40	14	AN	MACP2N

MASCHIO TESTA CONICA
COVEX FIXED MALE

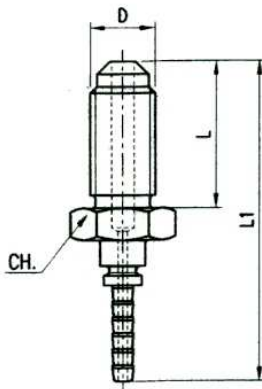

D	L	L1	CH.	Materiale Material	Codice Code
M10x1.25	23	50	14	AN	MALPON
M10x1	23	50	14	AN	MALP1N
3/8"-24	23	50	14	AN	MALP2N

MASCHIO FISSO
FIXED MALE

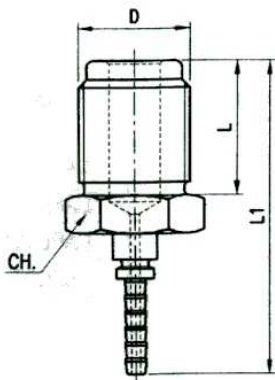

D	L	L1	CH.	Materiale Material	Codice Code
11/16"-16 fil./1"	21	46	19	AN	ML11/16PN

RACCORDI A PRESSARE PER TUBO FRENO A NORME SAE J 1401
SWAGED FITTINGS FOR BRAKE HOSE ACCORDING TO SAE J 1401

**FEMMINA FISSA
FIXED FEMALE**

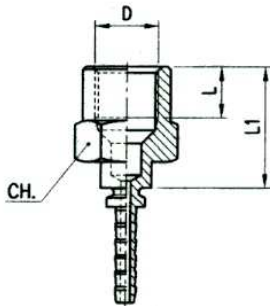

D	L	L1	CH.	Materiale Material	Codice Code
M10x1.25	8	19	14	AN	FACP0N
M10x1	8	19	14	AN	FACP1N
3/8"-24	8	19	14	AN	FACP2N

**FEMMINA FISSA LARGA
LARGE FIXED FEMALE**

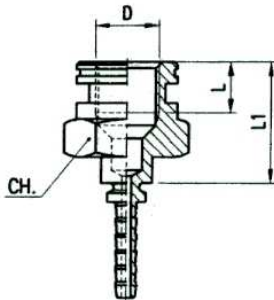

D	L	L1	CH.	Materiale Material	Codice Code
M10x1.25	8	20	17	AN	FALP0N
M10x1	8	20	17	AN	FALP1N
3/8"-24	8	20	17	AN	FALP2N

**CARCASSINA A PRESSARE
FERRULE**

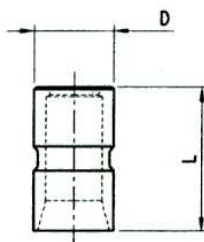

D	L	Materiale Material	Codice Code
9.5	18	AN	CAP001N
9.5	18	AL	CAP001E
11	18	AN	CAP002N
11	18	AL	CAP002E

RACCORDI A PRESSARE PER TUBO FRENO A NORME SAE J 1401
SWAGED FITTINGS FOR BRAKE HOSE ACCORDING TO SAE J 1401

MASCHIO/FEMMINA FISSO
FIXED MALE/FEMALE

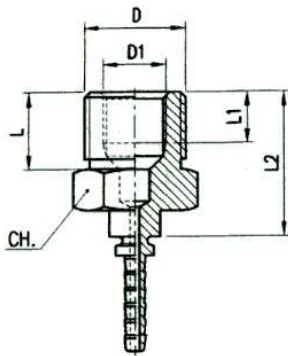

D	D1	L	L1	L2	CH.	Materiale Material	Codice Code
M16x1.5	M10x1.25	12	8	23	17	AN	MFALP0N
M16x1.5	M10x1	12	8	23	17	AN	MFALP1N
M16x1.5	3/8"-24	12	8	23	17	AN	MFALP2N

FEMMINA FISSA FRANCESE
FRENCH FIXED FEMALE

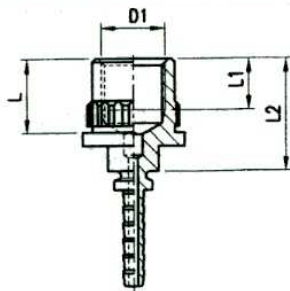

D	L	L1	L2	Materiale Material	Codice Code
M10x1	11.5	8	17.5	AN	FZP10-1N

GHIERA
LOCKNUT

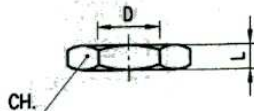

D	L	CH.	Materiale Material	Codice Code
M16x1.5	4	19	AN	GH1615N
M10x1.25	5	15	AN	DB100N
M10x1	5	15	AN	DB101N
3/8"-24	5	15	AN	DB102N